



## Name: 8" Rotary Wellpoint Pump

## Model: 8RW

The Thompson Rotary Wellpoint Pump is the original rotary wellpoint pump trusted by contractors worldwide for more than 40 years. The state-of-the-art 8RW is specifically designed and engineered for wellpoint and sock dewatering with high air handling, large water volume and high vacuum capability.



Photo shown may not be exact model.

Consult factory for other versions & options including site trailers, sound attenuation, etc.

Pump End Materials	
<b>Type</b>	Positive displacement, low-pulsation, self-priming, rotary lobe.
<b>Rotor</b>	Four-lobe, single piece design with carbon steel shaft and welded carbon steel fins with polyurethane coating.
<b>Rotor Housing</b>	Rugged, heavy-duty cast Aluminum.
<b>Mechanical Seal</b>	Oil lubricated with bronze rotating and steel stationary faces. Single inside mounted, non-pusher type with self-adjusting elastomeric bellows.
<b>Suction Tank</b>	A36 steel with permanent solids screen, 1-1/2" drain port, adjustable vacuum breaker valve and vacuum gauge for system diagnostics.
<b>Discharge Tank</b>	A36 steel with canvas reinforced neoprene weighted flapper style check valve; built-in reservoir with pressure relief and 1-1/2" drain port.
<b>Wear Plate</b>	Replaceable, 304 stainless steel.
<b>Bearings</b>	Heavy-duty, oil bath-pressure lubricated, cylindrical roller type.
<b>Bearing Housing</b>	Heavy-duty cast Aluminum.
<b>Canopy</b>	Removable drop-on sound enclosure, constructed of 18 gauge solid galvaneel shell and 1.5" thick, 8lb density mineral wool, with 5 lockable doors.

Technical Specifications			
Suction Size	8 in (20.32 cm)	Approximate Dry Weight	4,250 lbs (1,927.77 kg)
Discharge Size	8 in (20.32 cm)	Best Efficiency	71%
Maximum Solids Handling	Filtered Water Only	Displacement Volume	250 cfm
Maximum Operating Temperature	200° F (93.33° C)	Maximum Operating Pressure	34.6 psi (238.77 kPa)

Fuel Tank Options*	Deutz	Kohler
Modular (M)	127 Gal	47 Hours
Double-Wall (D)	94 Gal	35 Hours
Modular Large Capacity (X)	200 Gal	75 Hours
Double-Wall Large Capacity (Z)	150 Gal	56 Hours

\*Contact factory for fuel tank sizes not listed above.

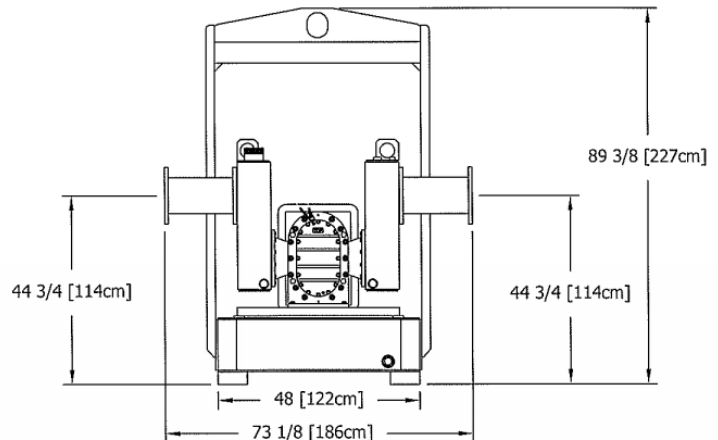
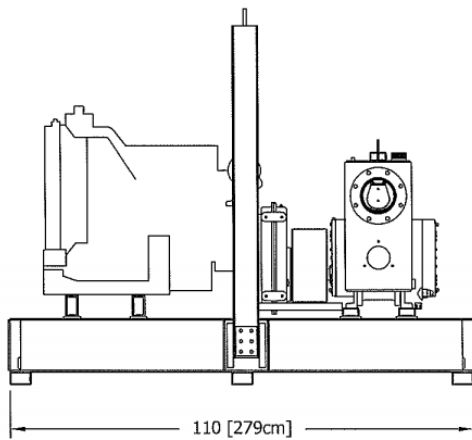
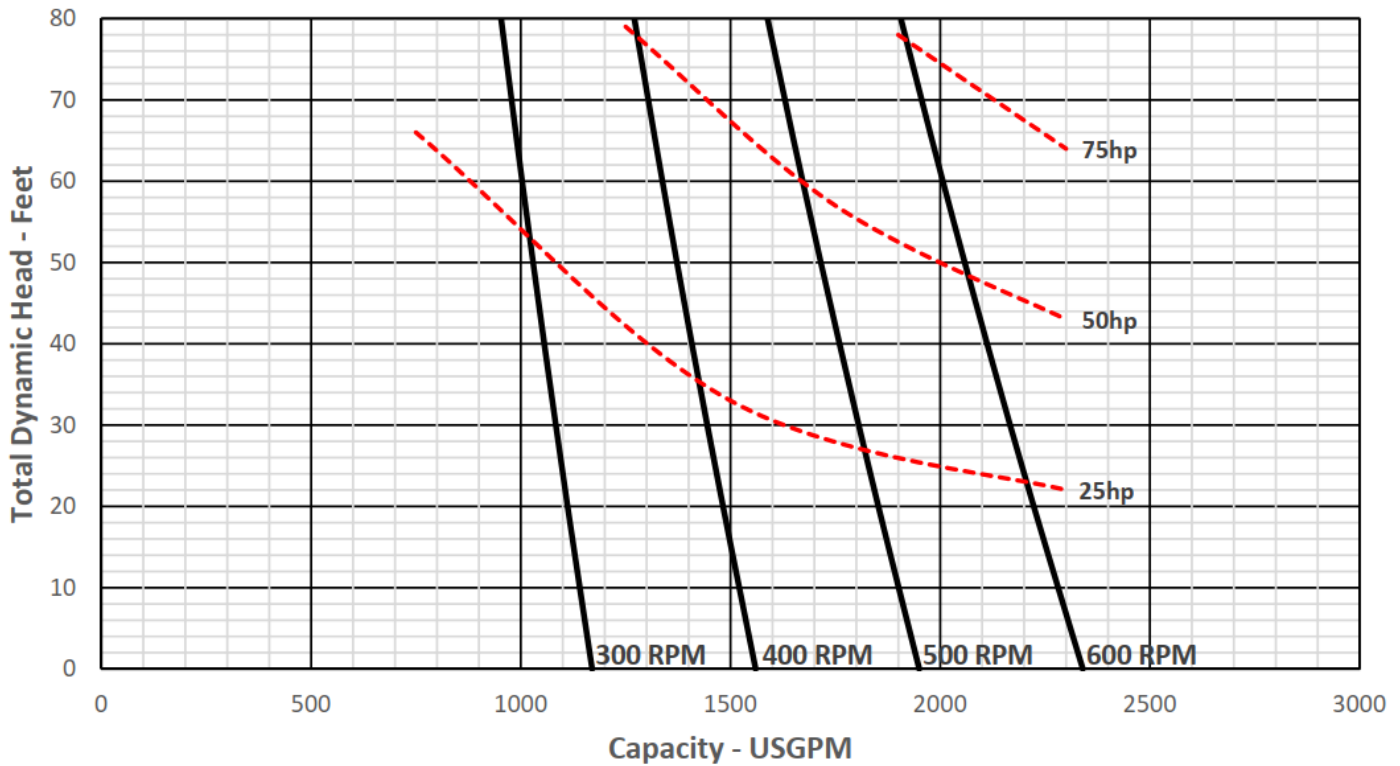

### Deutz TD3.6L4—74 hp @ 2,400 rpm

Typical Operating Speed	600 rpm	Pump Speed	Fuel Economy	Run Time*
Maximum Head	80 ft (24.38 m)	600 rpm	0.393 lb/hp-hr	28 hrs
Maximum Flow Capacity	2,330 gpm (528.91 m <sup>3</sup> /hr)	500 rpm	0.371 lb/hp-hr	34 hrs
Maximum Fuel Consumption	4.48 gph (16.96 L/hr)	400 rpm	0.359 lb-hp-hr	47 hrs

### Kohler CK25KDI—74 hp @ 2,400 rpm

Typical Operating Speed	600 rpm	Pump Speed	Fuel Economy	Run Time*
Maximum Head	80 ft (24.38 m)	600 rpm	0.373 lb/hp-hr	29 hrs
Maximum Flow Capacity	2,330 gpm (528.91 m <sup>3</sup> /hr)	500 rpm	0.355 lb/hp-hr	36 hrs
Maximum Fuel Consumption	4.25 gph (16.09 L/hr)	400 rpm	0.350 lb-hp-hr	48 hrs

\*Engine run times calculated based on a 127 gallon fuel tank.

Specifications and illustrations are subject to revision without notice and without incurring any obligation for previous or subsequent equipment sold. Thompson Pump (ISO 9001:2015) makes no representation regarding the completeness or accuracy of this information and is not liable for any direct or indirect damages arising from or relating to this information or its use. Capacity & Head are shown for comparative purposes. Consult Thompson factory for exact capabilities.